



# HONDA

## INSTALLATION INSTRUCTIONS

Accessory  
**WINCH MOUNT**  
**P/N OSL72-HL3-A00**

Application  
**SXS700 M2/M2D/M2F/**  
**M4/M4D/M4F**

Publication No.  
**MII 17775**  
 Issue Date  
**November 2022**

### PARTS LIST

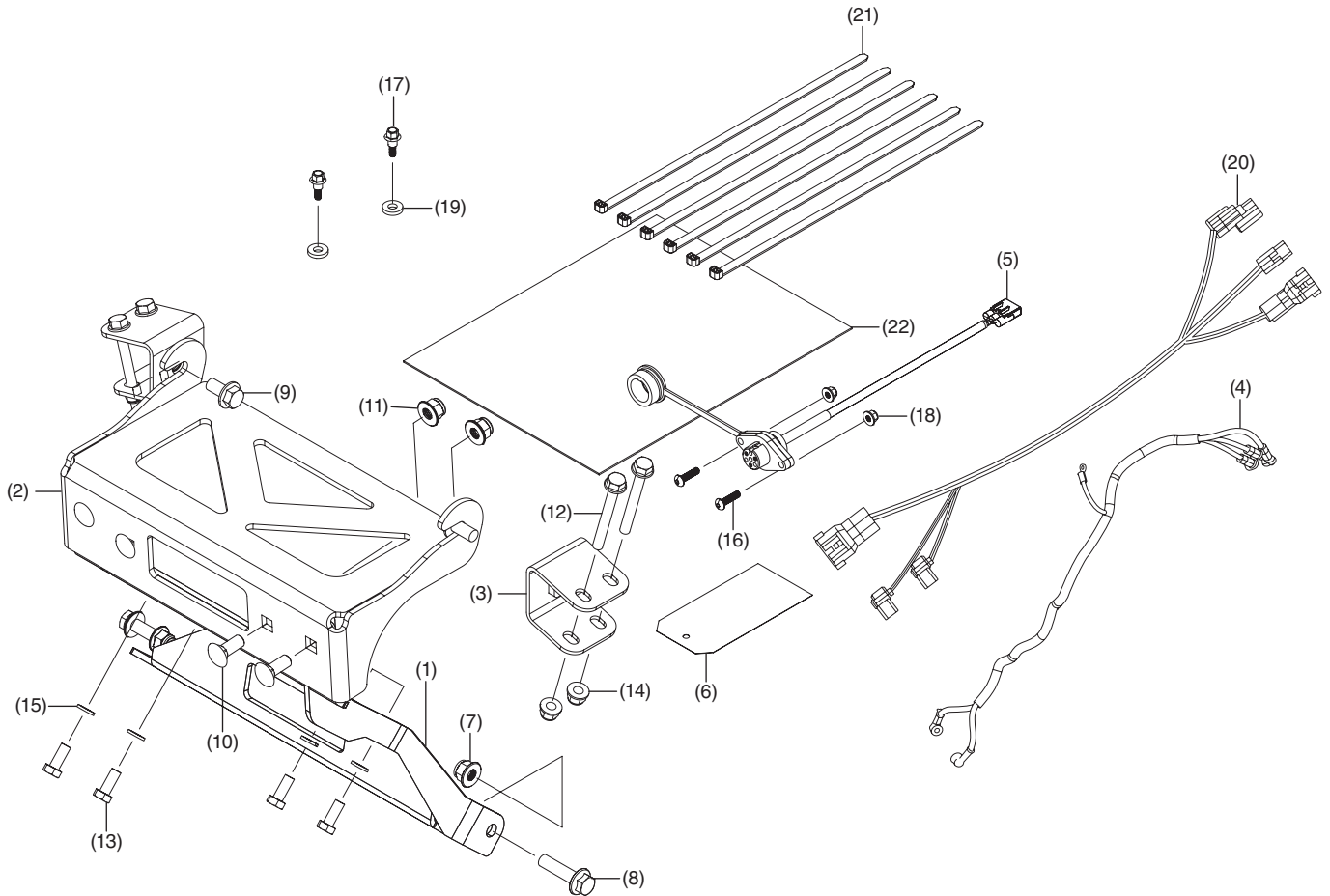

No.	Description	Qty
(1)	Winch bracket	1
(2)	Fairlead bracket	1
(3)	Fairlead C-bracket	2
(4)	Black, blue, and yellow cable	1
(5)	Remote socket	1
(6)	Warning tag	1
(7)	10 mm lock nut	2
(8)	10 × 40 mm flange bolt	2
(9)	10 × 20 mm flange bolt	2
(10)	10 × 25 mm carriage bolt	4
(11)	10 mm lock nut	4

No.	Description	Qty
(12)	8 × 70 mm flange bolt	4
(13)	8 × 20 mm bolt	4
(14)	8 mm flange nut	4
(15)	8 mm lock washer	4
(16)	5 × 20 mm socket bolt	2
(17)	5 mm shoulder bolt	2
(18)	5 mm lock nut	2
(19)	Rubber washer	2
(20)	Winch sub harness	1
(21)	Wire tie long	11
(22)	Installation Instructions URL	1

## REQUIRED ACCESSORIES

The items below are required for the installation of this accessory.

### WINCH

Sold separately (P/N 08L71-HL3-A43)

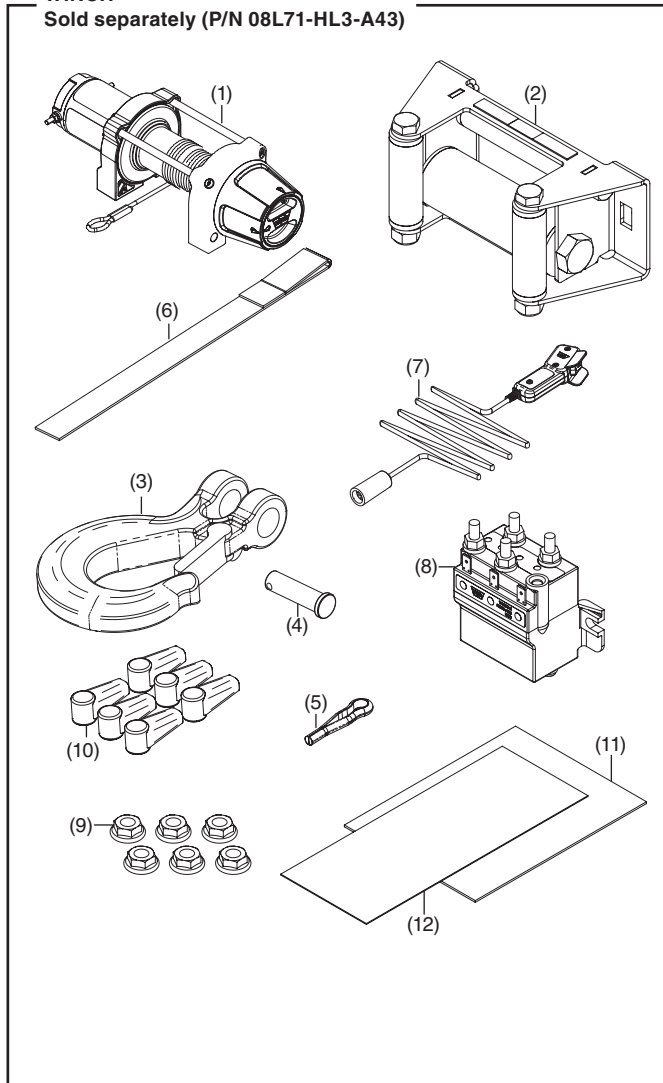

No.	Description	Qty
(1)	Winch	1
(2)	Roller fairlead	1
(3)	Hook	1
(4)	Clevis pin	1
(5)	Cotter pin	1
(6)	Strap	1
(7)	Remote control switch	1
(8)	Contactor	1
(9)	6 mm flange nut	6
(10)	Terminal boot	6
(11)	VRX axon product literature	1
(12)	Conformity CE declaration	1

### DASH SWITCH (OPTIONAL)

Sold separately (P/N 35380-HL4 -A010-M1)

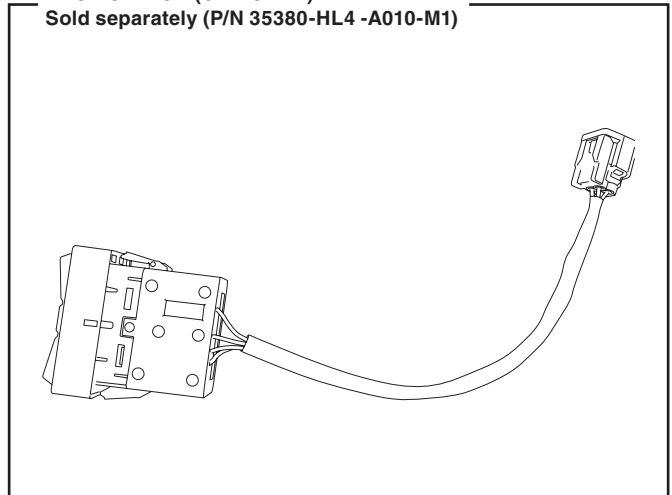

## CUSTOMER INFORMATION

The information in these installation instructions is intended for use only by skilled technicians who have the proper tools, equipment, and training to correctly and safely add equipment to your SxS. These procedures should not be attempted by someone without proper skills and equipment.

## BEFORE YOU BEGIN

This kit utilizes a WARN SxS winch. Please read WARN's Winching Technique guide provided with the winch prior to use of this product.

## TOOLS AND SUPPLIES REQUIRED

Socket, (8, 10, 12, 13, 14, 15 mm)  
 Open end wrench (12, 13, 15 mm)  
 Socket extension (6 inch)  
 Ratchet  
 Torque wrench  
 Hex wrench (3 and 5 mm)  
 Power drill  
 Drill bit (1/4 inch)  
 Step drill bit (with 7/8 inch capacity)  
 Awl

## TORQUE CHART

Tighten all screws, bolts, and nuts to their specified torque values. Refer to the Service Manual for the torque values of the removed parts.

Item	N-m	kgf-m	lbf-ft
4 mm screw	3.0	0.3	2.2
5 mm bolt and nut	5.2	0.5	3.8
6 mm bolt and nut	10.0	1.0	7.4
8 mm bolt and nut	22.0	2.2	16.2
10 mm bolt and nut	34.0	3.5	25.0

## USE AND CARE INFORMATION

- Check the accessory mounts frequently and retighten if necessary.
- Replace this accessory with a new one if it is damaged.
- Inspect all metal parts on the winch, winch mount and related hardware. Replace all parts that appear rusted, cracked, or deformed prior to use.
- Inspect all nuts and bolts on the winch, winch mount, and related hardware prior to each use. Tighten all nuts and bolts that are loose. Missing, stripped, fractured, or bent bolts or nuts need to be replaced immediately.
- Check all cables prior to use. Replace cables that are worn or frayed.
- Check all moving and rotating parts. Remove debris that may inhibit the free movement of any parts.

### **NOTICE:**

**Failure to perform regular inspections and maintenance on the winch, winch mount, and related hardware may result in vehicle damage.**

## SAFETY

When installing your SxS winch system, read and follow all mounting and safety instructions. Always use caution when working with electricity and verify that there are no exposed electrical connections before energizing the winch circuit. For specifications and performance data, refer to the specification sheet supplied with the winch.

### **NOTE:**

- **The 10 mm hardware included in this kit has two different thread pitches.**
- **Match the bolts with nuts before beginning installation to eliminate threading differently pitched hardware together. This will ensure a smooth installation.**

## INSTALLATION

1. Install all required accessories before starting installation.
2. Refer to the service manual to remove the front bumper.
3. Assemble the fairlead bracket to the winch bracket with the 10 mm carriage bolts and 10 mm lock nuts. Tighten the hardware to the specifications in the torque chart.

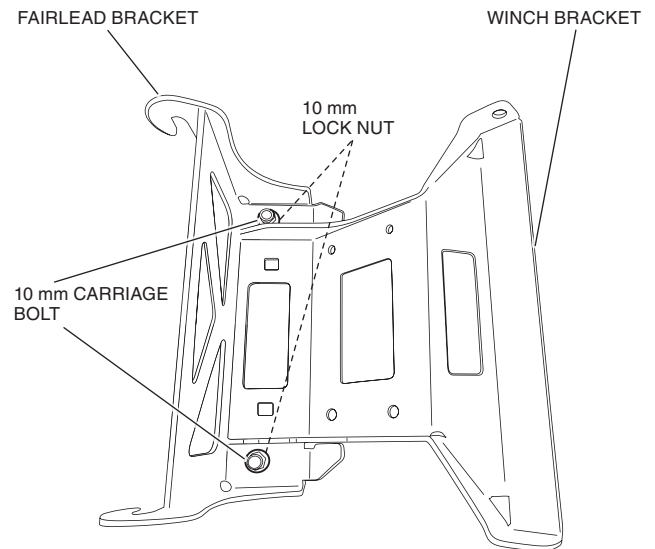

4. Install the fairlead onto the fairlead bracket using the remaining 10 mm carriage bolts and 10 mm lock nuts. Tighten the hardware to the specification in the torque chart.

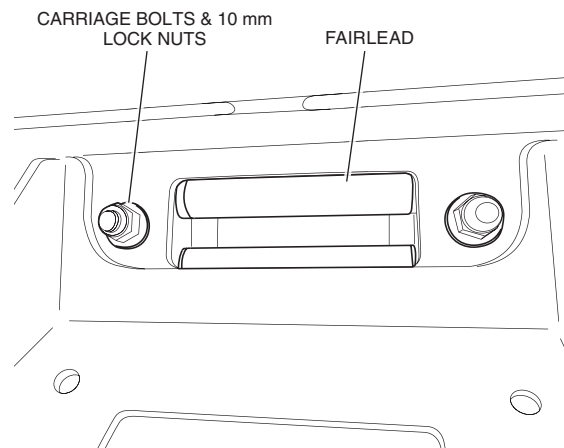

5. Install the winch onto the winch bracket using four 8 × 20 mm bolts with 8 mm lock washers. Be sure that the plastic clutch cover is on the right side of the vehicle and the winch cable goes through the fairlead opening.

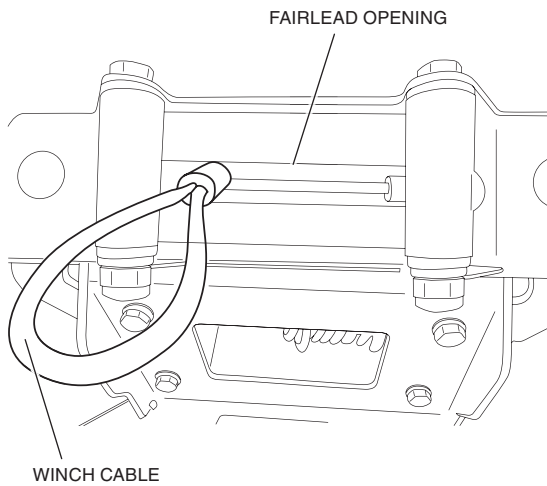
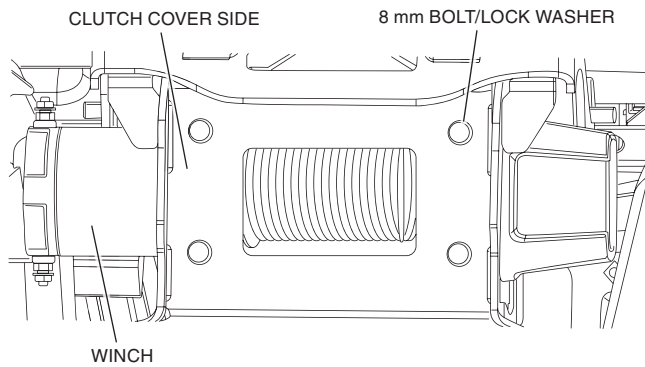

6. Loosely install the fairlead C-brackets using the 10 × 20 mm flange bolts. The brackets will be adjusted and tightened in a later step.

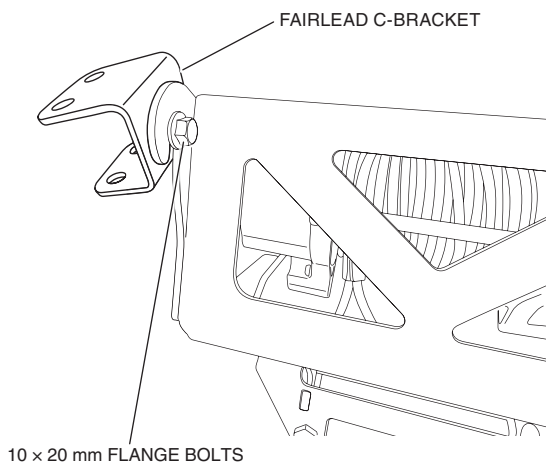

## Two people are required for steps 7 & 8

7. Hang the winch assembly from the front bumper brackets as shown.

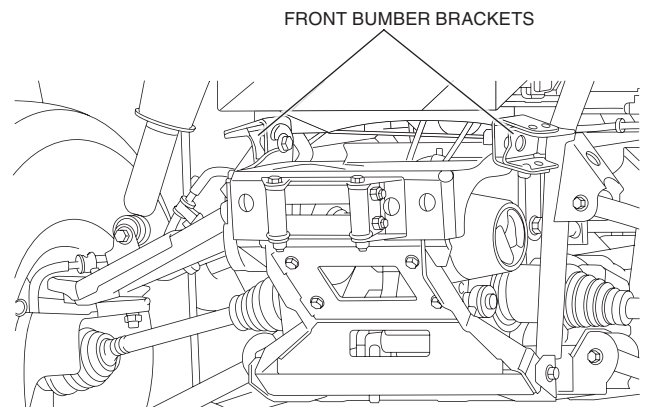

8. While one person supports the winch, have the other person place the front bumper into position and insert four 8 × 70 mm flange bolts through the C-brackets and upper supports.

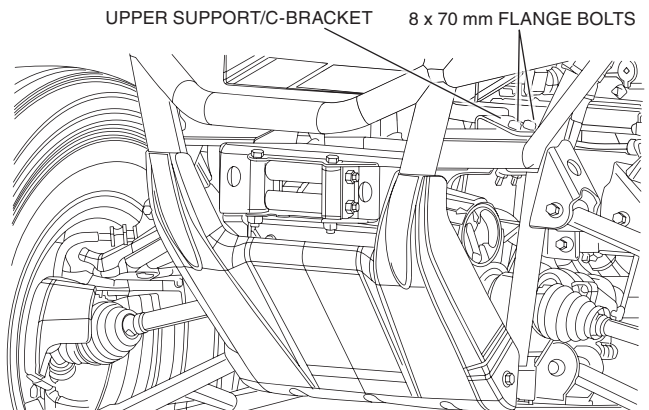

9. Install the 10 × 40 mm flange bolts through the lower bumper mounts and tighten them until the bolt emerges through the inside of the winch bracket.

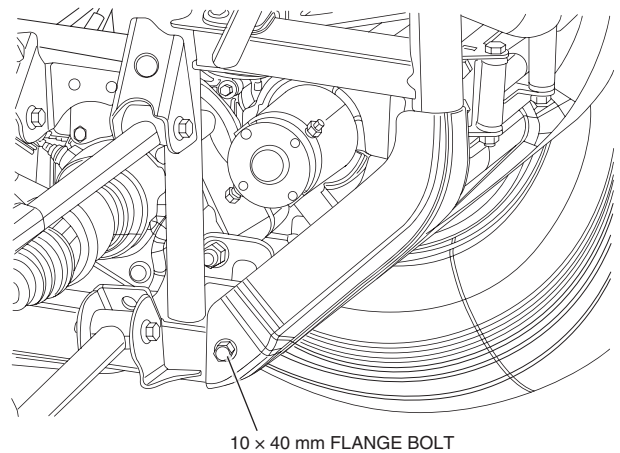

10. Install the 10 mm lock nuts on the bolts installed in step 9. Hold the bolts as you tighten the nuts to the specification in the torque chart.

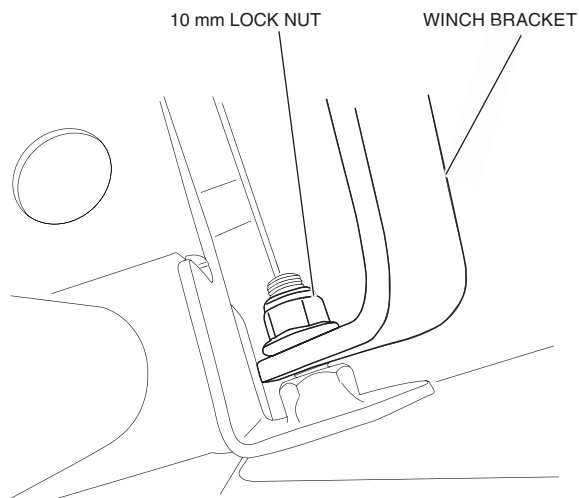

11. Install 8 mm flange nuts on the four bolts installed in step 8 and tighten them to the specification in the torque chart.

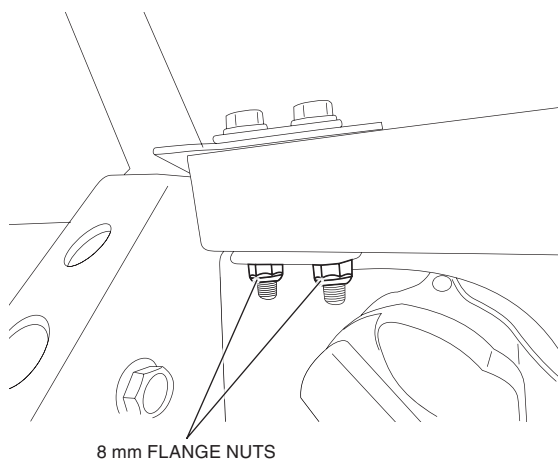

12. Tighten the inner C-bracket bolts to the specification in the torque chart.

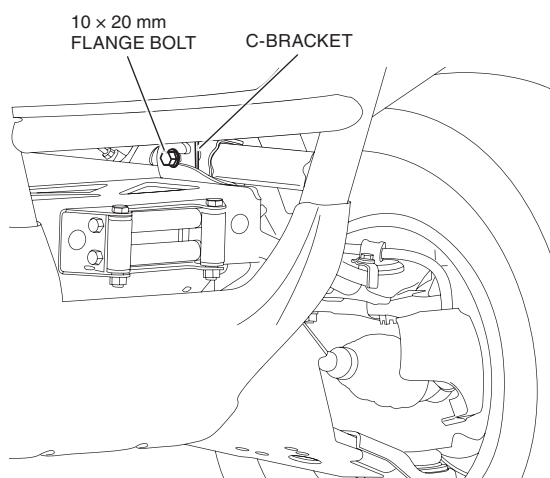
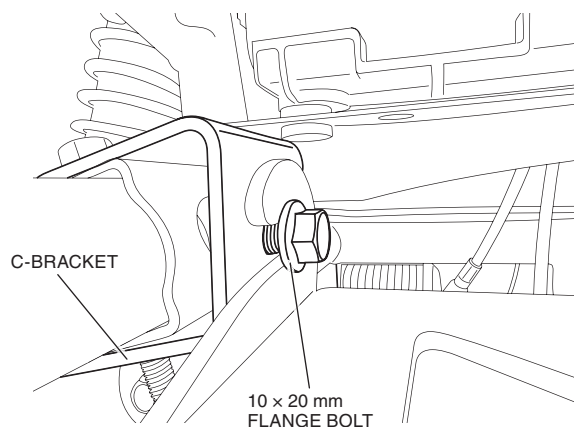

13. Install the clevis hook assembly using the instructions supplied with the warn winch.

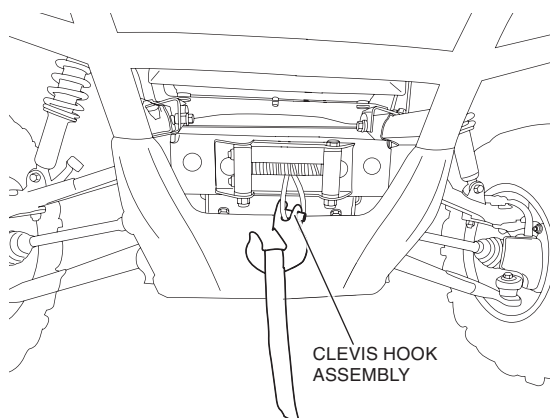

14. Proceed to the ELECTRICAL INSTALLATION section.

## ELECTRICAL INSTALLATION

- Disconnect the negative (-) cable from the battery before installing this accessory.
- The memory of the clock will be erased when you disconnect the battery. Reset the clock after reconnecting the battery.

1. Remove the front hood.

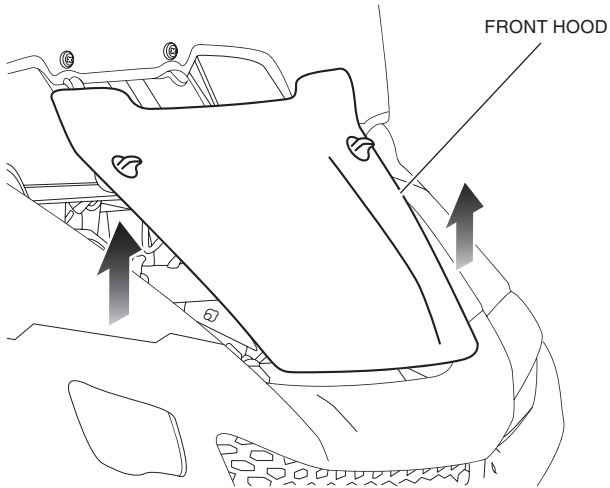

2. Remove the front seat.

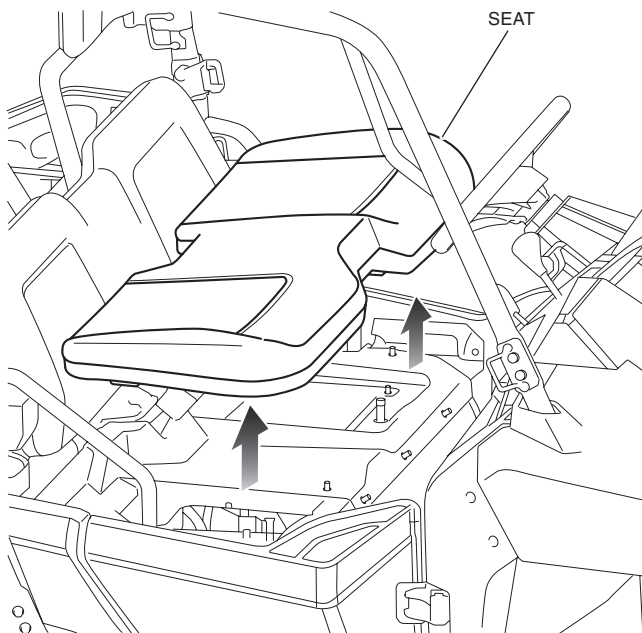

3. Disconnect the negative (-) battery cable from the battery.

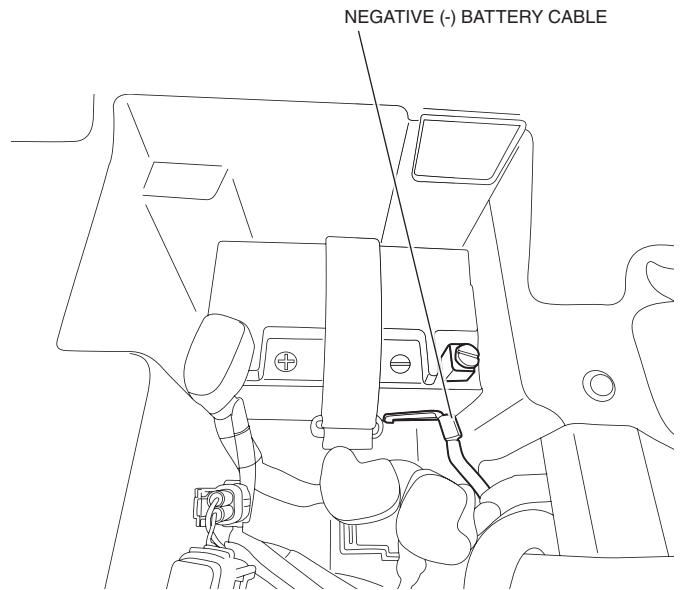

4. Disconnect the vehicle frame ground and add the winch black (ground) cable. Reinstall the frame ground terminal bolt.

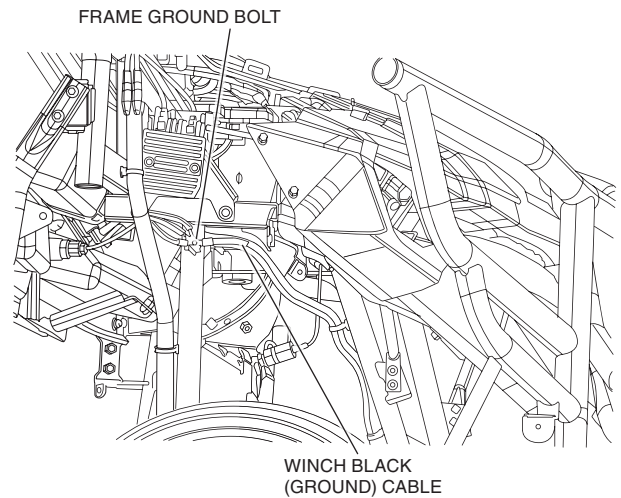

5. Start routing the winch black, blue and yellow cable as shown.

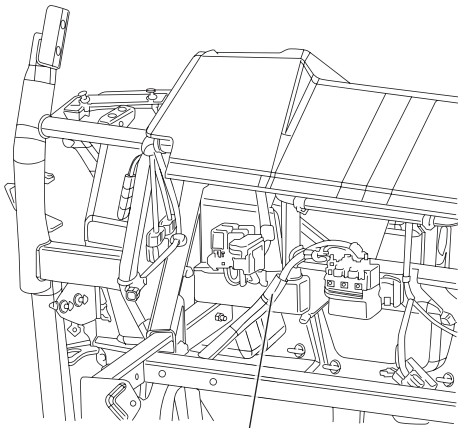

WINCH CABLE  
(BLACK, YELLOW AND BLUE)

6. Remove the nut from the battery-side of the starter relay switch and install the winch red cable to the terminal as shown. Angle the winch red cable as shown. Don't reinstall the starter relay switch nut, until all the wiring is done.

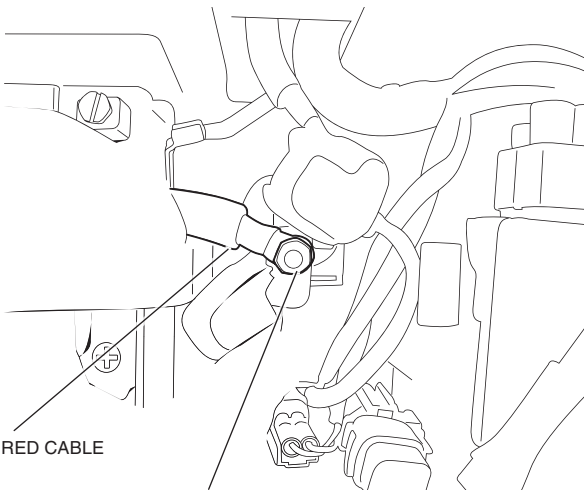

WINCH RED CABLE

STARTER RELAY SWITCH NUT  
(BATTERY SIDE)

7. Cover the starter relay switch terminal with the black boot.
- This will require cutting a slit in the black boot as shown.

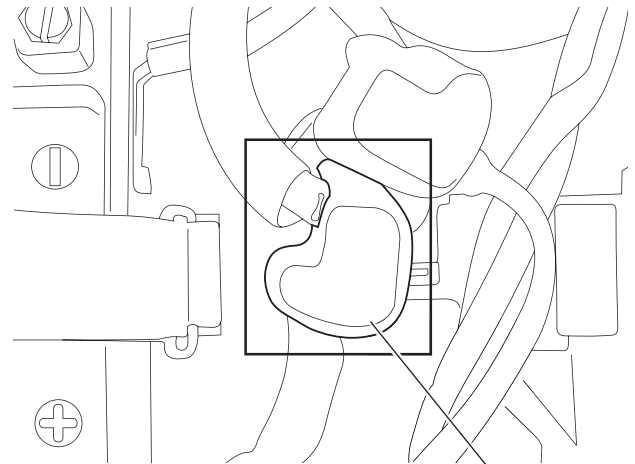

BLACK BOOT

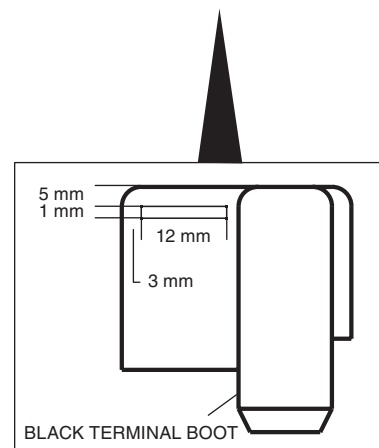

BLACK TERMINAL BOOT

8. Install the contactor onto the frame using the two rubber washers, two 5 mm shoulder bolts as shown.

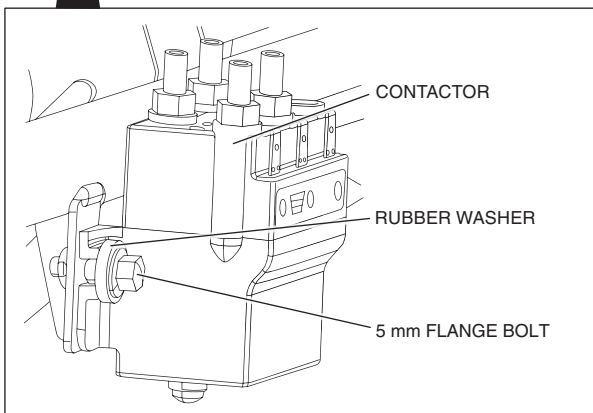
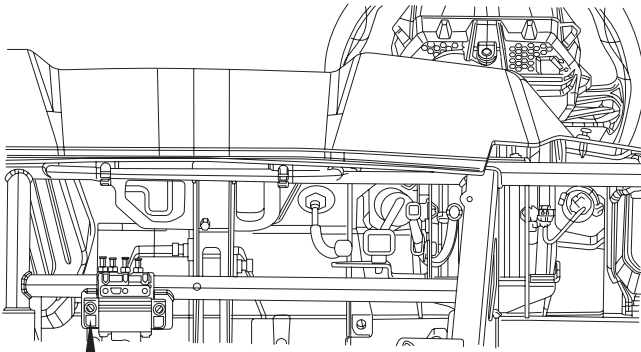

9. Install terminal boots to both ends of the winch red, black, blue, and yellow cable ends as shown.

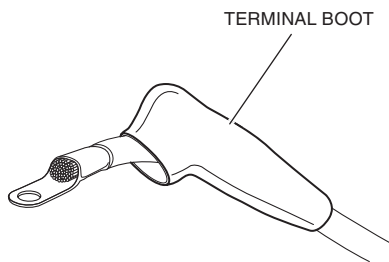

10. Remove blue tape from main harness to expose winch red cable.

Install the winch red cable to the contactor red terminal.

Install the winch blue and yellow cables to their corresponding color contactor terminals.

Install the winch black cable to the contactor black terminals.

Tighten the terminal nuts to 4.5 N·m (See Warn Instructions).

Pull the terminal boots over the terminals and nuts as shown.

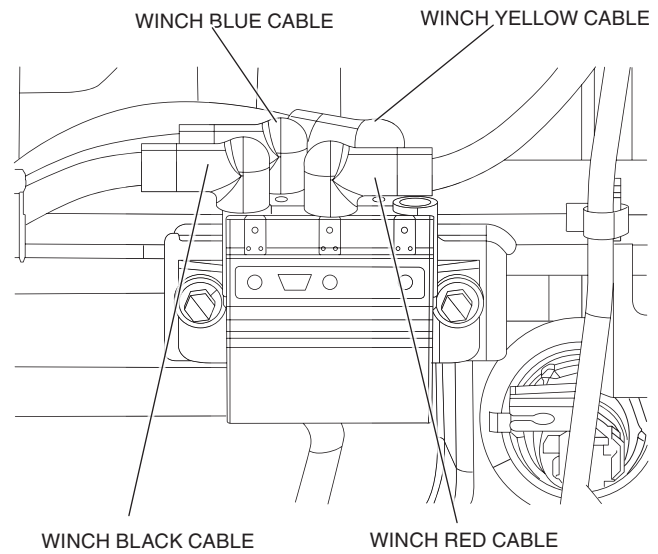

11. Cut out the winch remote socket drilling template from page 12 and tape it to the inside of the glove box at the indicated position.

Make marks on the glove box by pushing an awl through the drill marks on the template.

Remove the drilling template. Drill the two 1/4 inch holes and the 7/8 inch hole at the marked locations.

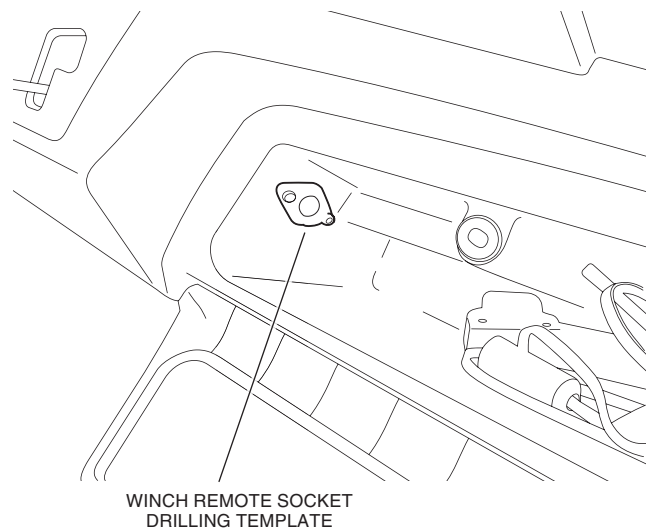



12. Install the winch remote socket to the glove box with the two 5 × 20 mm socket bolts & 5 mm lock nuts. Tighten the hardware until the lock nut engages the plastic. Then turn the lock nut an additional half turn.

<VIEW FROM BACK SIDE OF GLOVE BOX>

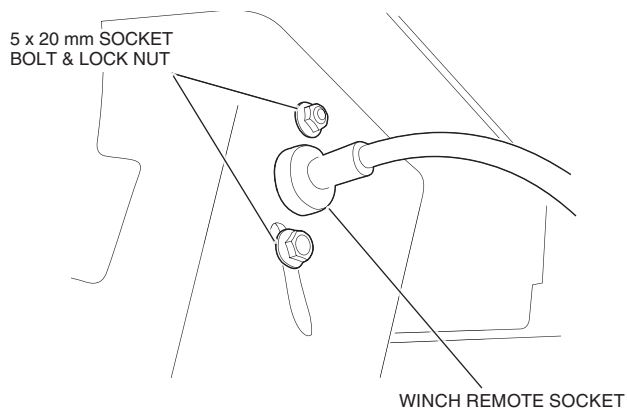

13. Connect the winch sub harness black and green wires to their corresponding color contactor terminals.

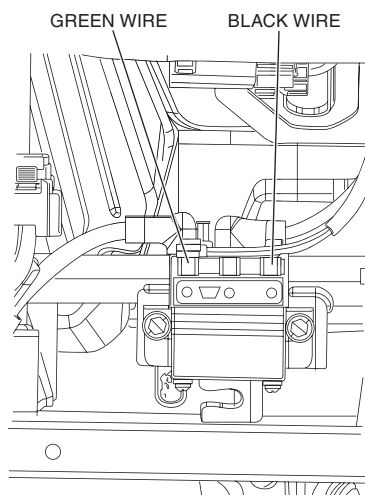

14. Connect the winch sub harness 3 pin connector to the remote socket connector.

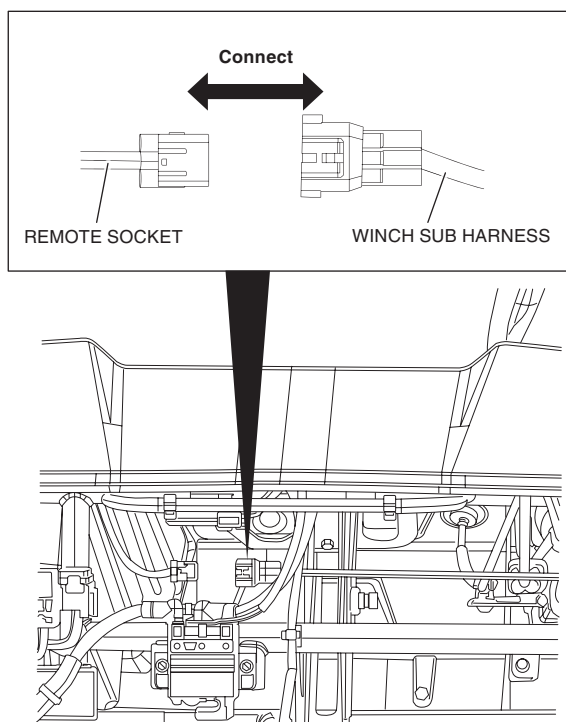

15. Add dummy plug to the male coupler on winch sub harness. Winch Switch assembly (Sold separately) can be connected by connecting the winch sub harness 5 pin connector (black) to the winch switch connector.

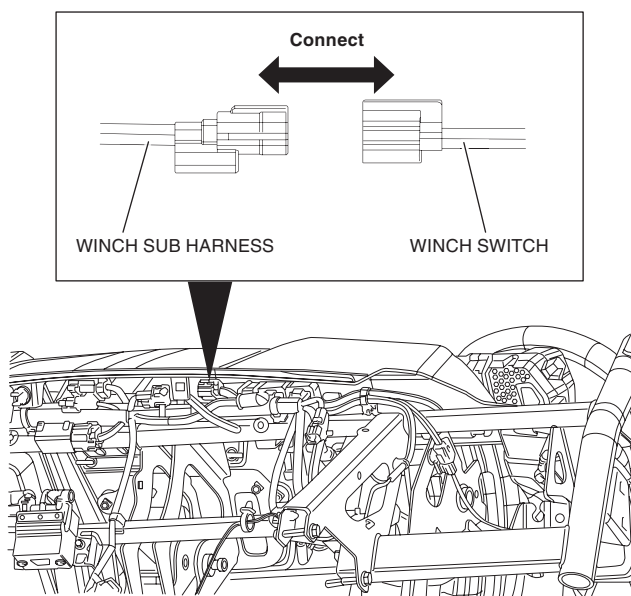

16. Connect the winch sub harness 2 pin coupler to the main harness coupler by following the steps below:
- Remove dummy plug from 2 pin coupler (keep it).
  - Connect female coupler to the main harness coupler.
  - Add dummy plug to male coupler on winch sub harness.

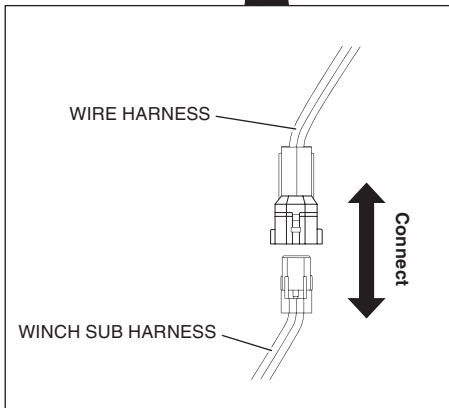
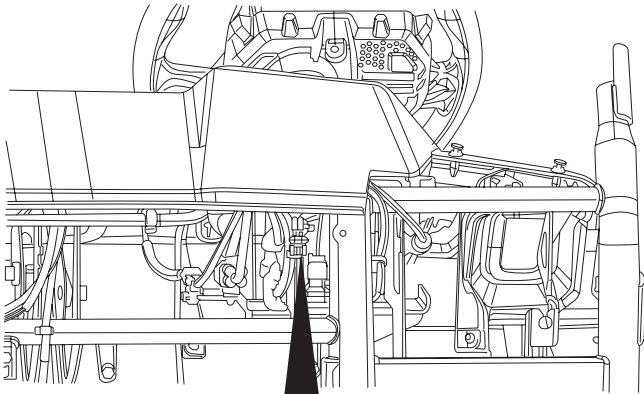

17. Secure the winch blue, yellow and black cables with the harness band clip as shown.

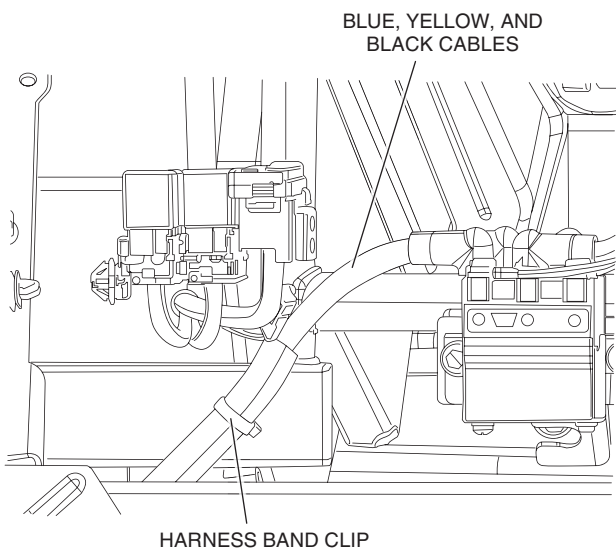

18. Route the winch blue, yellow and black cables down the frame and secure them with the harness band clip as shown.

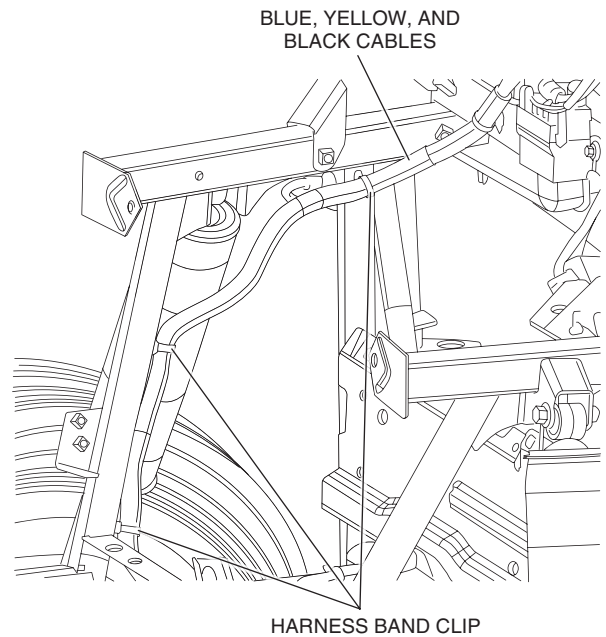

19. Connect the winch yellow and blue cables to their corresponding color terminals on the winch motor. Tighten the terminal nuts securely and pull the covers over the terminals and nuts. From this point forward, the winch blue and yellow cables will be referred to as the "winch power" cables.

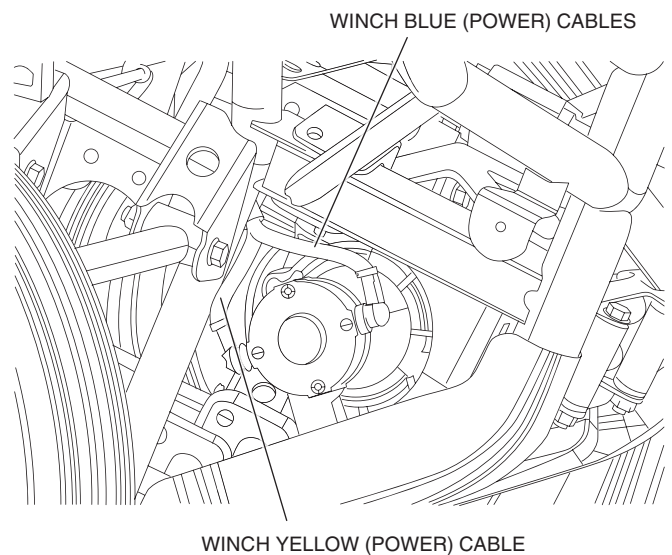

20. Install the negative battery cable and terminal bolt.

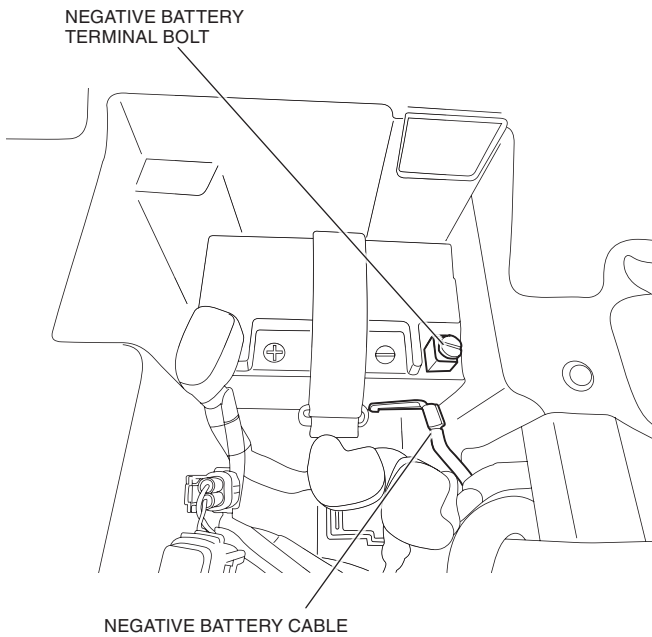

21. Reinstall the starter relay switch nut on the battery side.

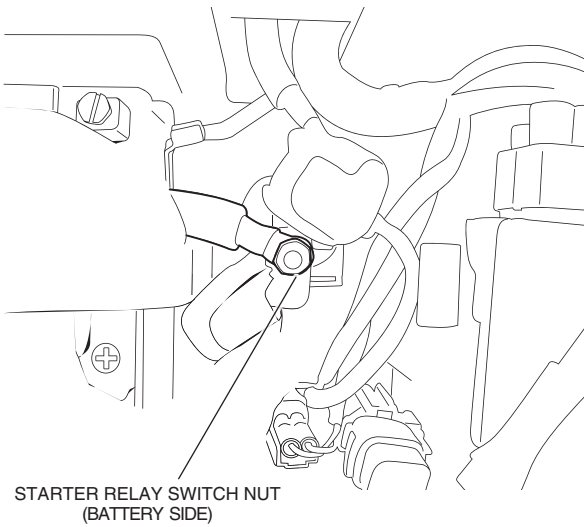

## CHECK THE SYSTEM

Before reassembling the vehicle or using the winch, verify the following:

- The wiring to all components is correct. All loose wires are secured with zip-ties.
- There are no exposed terminals (except the chassis ground bolt) or wiring. Cover any existing terminal exposures with terminal boots, heat shrink tubing or electrical tape.
- Turn the vehicle ignition switch to the ON position. Check the winch for proper operation. The wire rope should spool in and out in the direction indicated on the remote.

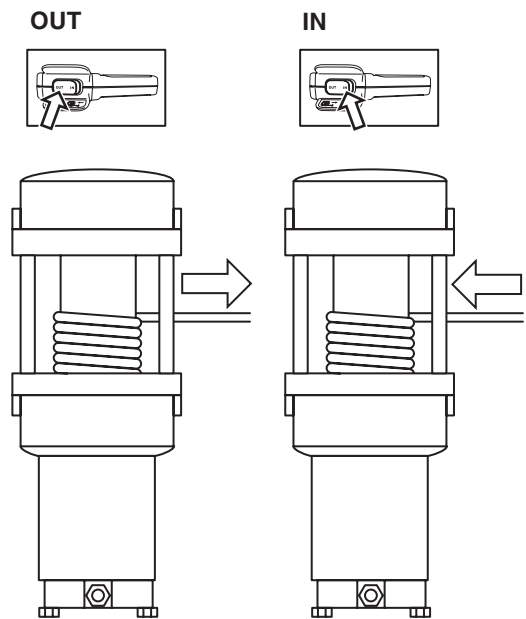

# WINCH CONTROL RECEPTACLE DRILLING TEMPLATE

Cut out the drilling template at the dotted line.

